

CLAMPS FOR ANTI TWIST ROPE

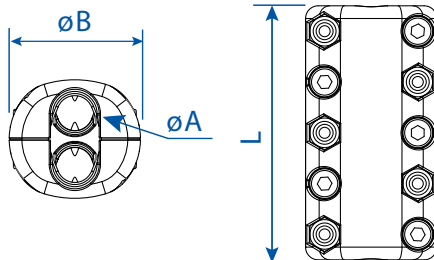

In order to facilitate the installation of **anti-torsion ropes** by sailmakers, Facnor has developed a range of highload clamps (Duplex Marine quality stainless steel) : 4 models fitted from 9,5mm to 15 mm \varnothing :

- Adapted shape for lashing
- Complementary to Facnor thimble range
- Quick assembly (three types of assembly : with long screws for manual preassembly, with vice or with hydraulic press machine thanks to a special tool)
- Kit including clamp + S/S screws (including long screws for preassembly) + thermoshrinkable sleeves
- **IMPORTANT:** For use on Code sails FRC clamps have been validated with Marlow Pro-Drive Plus AT rope only for the time being. The use with any other AT rope brand or model is not under our responsibility.



CLAMPS

Model	References	\varnothing A.T. Rope* (mm)	Dimensions		
			\varnothing A (mm)	\varnothing B (mm)	\varnothing L (mm)
FRC D09 mm	24000091090	9,5	8,5	29	56
FRC D11 mm	24000091110	11	10	31	60
FRC D13 mm	24000091130	13	12	35	62
FRC D15 mm	24000091170	15	15	40	100