

ANTI-TORSION ROPES & FX+ OPTIONS

Flying sails like Gennaker, Code 0 or Asymmetric Spinnaker fitted on furlers are supplied with an **anti-twist luff rope**, to transmit the rotation down to the top of sail. For an optimum revolution the jaws of furler mechanisms are connected to the luff rope thimbles. And for an optimum halyard tension, a two-to-one block can be fitted.

Snatch blocks

- in case of high load, they reduce the halyard load on the sheave box; connected above the swivel or underneath the drum.

LB LIGHT SNATCH BLOCK					
Model	Ø Sheave	SWL	B (mm)	Weight (g)	Reference
LB02T	41	1,5T	59	99	43180402040
LB03T	46	2,5T	64	141	43180403040
LB04T5	55	4,5T	79	249	43180404540
LB07T	70	7T	90	461	43180407040
LB09T	88	9T	110	897	43180403040
LB15T	123	15T	160	2068	43180415040

The thimbles

- Adjusted to the mechanism jaw for a optimum transmission in rotation.

FCI / FCA / FC+ STANDARD THIMBLES						
Model	FX+/FXT/FAST Ref.	Rope Ø (mm)	Axis A (mm)	WAF	R	Reference
FCI 1500	FX+ 1500	9 → 11	8	14,5	15	25200010110
FCI 2500	FX+ 2500	11 → 13	10	17	18,5	25200010112
FCI 4500	FX+ /FXT 4500	13 → 15	12	18,5	22	25200010114
FCA 7000	FX+ /FXT 7000	16 → 22	14	25	35	43130237030
FCA 12000	FX+ 12000 std	16 → 22	16	25	35	43130231220
FCA 12000	FX+ 12000 race	16	18	21	35	43130231230
FC+ 20000*	FX+ 20000 std	20 → 24	20	28	41	43130232020
FC+ 20000*	FX+ 20000 race	20 → 24	29	30	41	43130232030

\* 2 models : Standard & Racing for FCA 12000 & FCA+ 20000

FCL CABLE LESS THIMBLE			
Model	FX/FXT Ref.	TOP Reference	BOTTOM Reference
FCL 900/1500	FX+ 2500	43130240010	43130250010
FCL 2500	FX+ /FXT 2500	43130240020	43130250020
FCL 4500	FX+ /FXT 4500	43130240040	43130250040
FCL 7000	FX+ /FXT 7000	43130240070	43130250070
FCL 12000 Racing	FX+9000/12000 racing / STK 9T	43130240071	43130250071

Smart toggle Cyclops Marine

- Plug and lay system. Effort measured in real time via bluetooth. STCM 4500 (for FX+4500). Ref. 43130160450 Contact us



CLAMPS FOR ANTI TWIST ROPE



In order to facilitate the installation of **anti-torsion ropes** by sailmakers, Facnor has developed a range of highload clamps (Duplex Marine quality stainless steel) : 4 models fitted from 9,5 mm to 15 mm  $\varnothing$  :

- Adapted shape for lashing
- Complementary to Facnor thimble range
- Quick assembly (three types of assembly : with long screws for manual preassembly, with vice or with hydraulic press machine thanks to a special tool)
- Kit including clamp + S/S screws (including long screws for preassembly) + thermoshrinkable sleeves
- **IMPORTANT:** For use on Code sails FRC clamps have been validated with Marlow Pro-Drive Plus AT rope only for the time being. The use with any other AT rope brand or model is not under our responsibility.

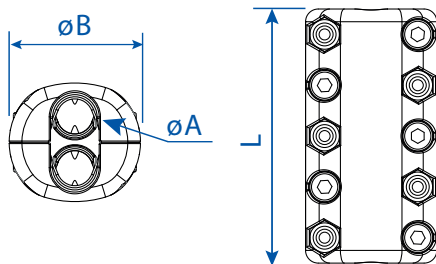

CLAMPS					
Model	References	$\varnothing$ A.T. Rope* (mm)	Dimensions		
			$\varnothing$ A (mm)	$\varnothing$ B (mm)	$\varnothing$ L (mm)
FRC D09 mm	24000091090	9,5	8,5	29	56
FRC D11 mm	24000091110	11	10	31	60
FRC D13 mm	24000091130	13	12	35	62
FRC D15 mm	24000091170	15	15	40	100

**Anti-twist swivel for Spinnaker :**  
For Spinnaker or Mainsail halyards

- Anti-twist
- Simple & compact
- Duplex stainless steel or titanium (4T5 only)
- 1T5 / 2T5 / 4T5

(See also page 56)

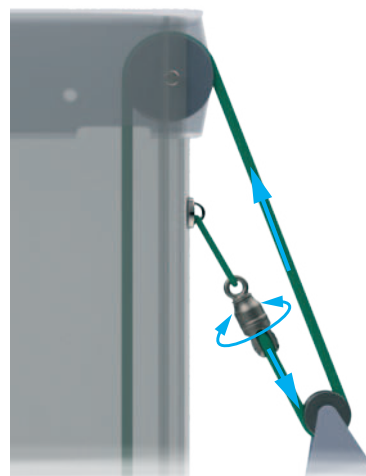

ANTI-TWIST SWIVEL



**Solid sheaves :**

material : Duplex stainless steel see use for asymmetric Spinnaker (page 36) or Staysail (page 33)

SOLID SHEAVE

SSH SOLID SHEAVE				
Model	FX/AFX Ref.	Height (mm)	weight (g)	Reference
SSH+ 1500	FX+ 1500	53	173	43354320153
SSH+ 2500	FX+ 2500	60	226	43354320253
SSH+ 4500	FX+ 4500	69	280	43354320453
SSH+ 7000	FX+ 7000	73	350	43354320543
SSH+12000	FX+ 12000	84	415	43354320943

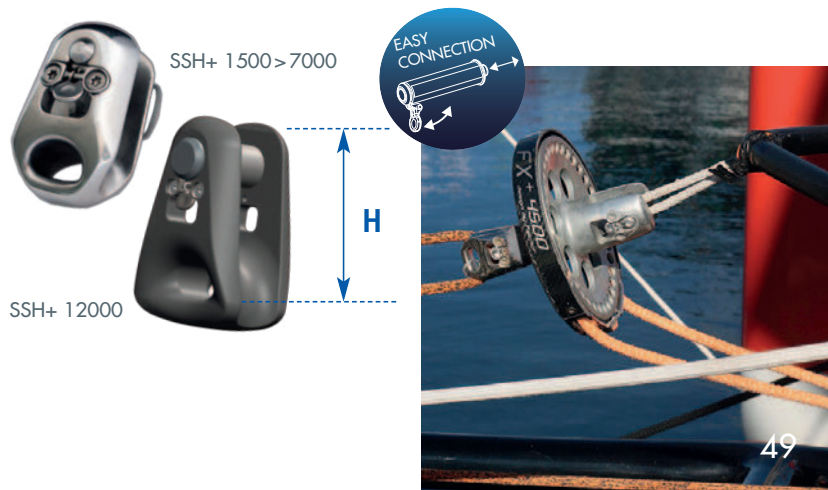

COVERS FOR DRUM & SWIVEL

**Continuous line drum covers:** ideal for protecting your continuous line furlers from deck impacts. The cover is made of padded PVC and assembled with thick and strong strips. Standard available from FX+ 2500 up to FX12000.

FX+ Drum	FX+ 2500	FX+ 4500	FX+ 7000	FX+ 9000 FX+ 12000
REFERENCE	29050000076	29050000056	29050000060	29050021200

FX+ & FXT SWIVEL	FX+ 900 FX+ 1500	FX+ 2500	FX+ / FXT 4500	FX+ / FXT 7000
REFERENCE	29050010150	29050010250	29050010450	29050010700



**Swivel protection covers (neoprene):** an additional benefit of securing the mast and the sailing crew. Delivered in FX+ standard kit : FX+ 2500, FX+ & FXT 4500, FX+ & FXT 7000.

BOWSPRIT FOR GENNAKERS & ASYMETRICAL SPINNAKERS



from 25 up to 57'

Simple and efficient functioning



Bridle attachment



Automatic locking device

■ The central fixing collar is removable from the fixing block. The foredeck is therefore totally free.

■ Rotating collar captive from the section: removable bowsprit for storage alongside one boat edge



- Automatic locking device on deck fixing blocks;
- Simple installation (only a short backwards movement is needed to fit the bowsprit on the deck);
- Quick removal & storage on a third fixing block;
- Integrated line stopper for holding the tackline.



integrated line stopper

Complete kit including :

- Aluminium bowsprit with special end fittings : bridle attachment at the front and fixing block device at the back (delivered pre-installed);
- Adjustable Central fixing collar + Deck fitting blocks and two counter plates.

Technical data

ø section (mm)	Total length (mm-feet)	Mini. length inside (mm-feet)	max. length outside (mm-feet)	Use example boat length (feet)	Max sail area (m <sup>2</sup> )		Fitting FX+ & FX+SPI models
					Asym. Spi.	Gennaker & code zero	
ø 70	1600	800	800	25-36'	60	37*	1500/2500
ø 80	1800	900	900	36-40'	82	52*	2500/4500
ø 90	1900	950	950	40-47'	102	65*	4500/7000**
ø 100	2000	1000	1000	48-57'	130 / 150*	105*	4500/7000**

\*with bridles \*\* FX+7000 with snap shackle option

Articulating toggle (option) for Gennaker / Code zero furler attachment



Bridle kit (option)



■ **Options :** «working» and «parking» deck fittings, deck fitting covers, stemhead fittings, bridle kits, furler fitting ring (Gennaker attachment)...